

North Arrow

**MINIMUM POOL SETBACKS:**  
 1) POOL: 1.22 m (4' 0" FT) FROM ANY LOT LINE.  
 2) POOL TREATMENT EQUIPMENT: 0.9 m (3' 0" FT) FROM ANY LOT LINE.

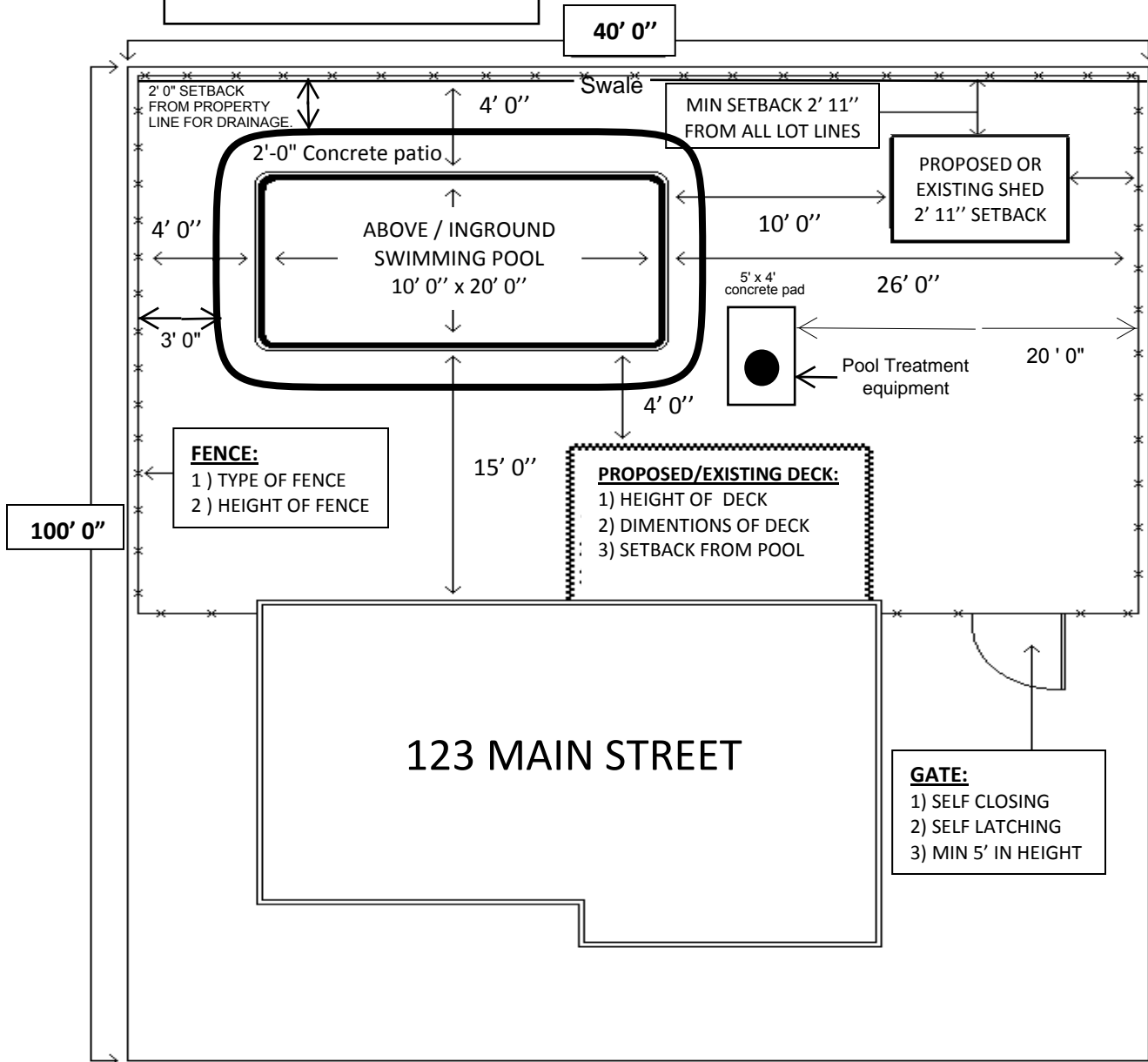

**SITE PLAN**

**INFORMATION REQUIRED ON SITE PLAN:**

Draw to scale and dimension the following:

**\*\*A RULER MUST BE USED\*\***

- Provide dimensions of existing lot size and indicate property line.
- Show all swales/ ditches/ drainage/ rear yard catch basins and provide setbacks to proposed pool and main building.
- Provide setbacks and dimensions of all existing buildings and structures.
- Show location and size of proposed pool, indicate above ground or inground.
- Provide setbacks from the waters edge of the pool to the main building and all lot lines.
- Show location and size of any existing and/ or proposed accessory structures (ie: shed).
- Provide setbacks from any existing and/ or proposed accessory structures to all lot lines.
- Show any existing and/or proposed decks, indicate existing or proposed.
- Provide dimensions and height of deck.
- Show location of existing and/ or proposed fence.
- Provide height of fence and type of construction.
- Show all existing and/ or proposed concrete/ grass areas.
- Provide dimensions of concrete/ patio areas.
- Show all easements.
- Show North Arrow.

Zoning By-law 2667, as amended:  
**Section 5.4 (b) Pools:**  
 Open air swimming pools shall be located outside of the FRONT YARD with a minimum setback of 1.2 meters from any LOT LINE or main BUILDING.