

Permit Parking Only
\$ 20.00/month

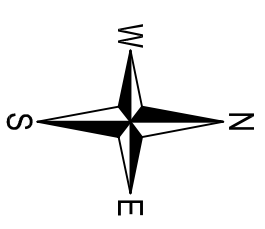

PARKING LOT

PLYMOUTH ROAD

CHURCHILL AVENUE

PLYMOUTH PARK

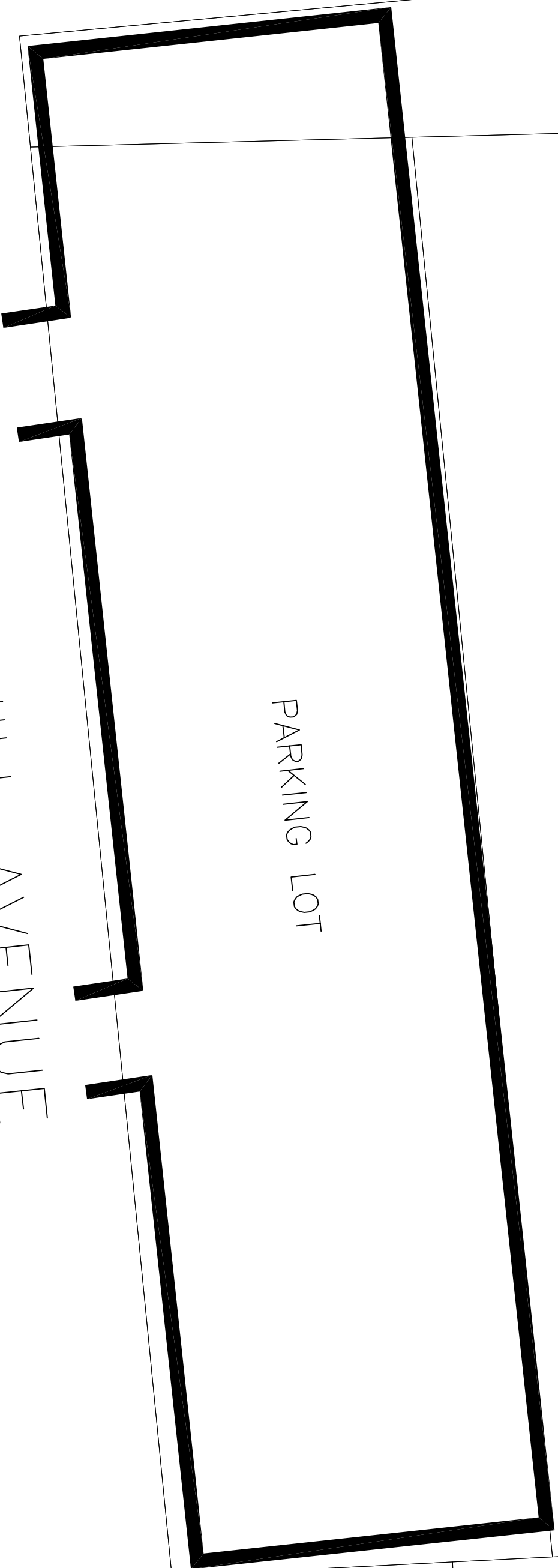

DRAFTING BY:
Kyle Guglielmo

CHECKED BY:
D. Cronshaw

APPROVED BY:
Dave Ferguson

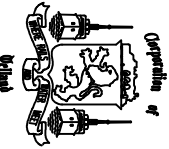
CITY OF WELLAND
ENGINEERING DEPARTMENT

Lot 9 Churchill Avenue Parking Lot

CAD FILE NAME:
Churchill.dwg

DATE:
Sept 17, 2008

SCALE:
NTS

DRAWING No.
1 of 1

REV.

I:\Traffic & Parking Dwg\2007\Parking lots-2007\Churchill.dwg